

# SMR SERIES SANITARY STAINLESS STEEL MULTI-ROUND FILTER HOUSING

## Introduction:

The high purity Sanitary Cartridge Housings are designed to meet your critical processing needs.

These housings are commonly used in Pharmaceutical, Biological, and API applications. Housings exceed standards for sterile filtration. The 316L Stainless Steel housings have been designed to meet ASME BPE. The highly polished corrosive-resistant material is ideal because of its superior strength and chemical compatibility.

The housings are available in both 222 and 226 O-ring filter configuration. Housings of 3 to 100 round elements are available. Housings are designed for complete disassembly, allowing full access to all internal surfaces for easy cleaning. Sanitary tri-clamp vents and drains allow easy venting, draining, and sampling. Secure swing-away bolt closure design.

## Features

- *Aseptic Design*
- *Low Hold Volume*
- *Sanitary Vents & Drains*
- *Swing Away Bolts*
- *Large Dome Handles*



## Applications

- *WFI*
- *Buffers*
- *Reagents*
- *Biologicals*
- *API Applications*
- *Pharmaceuticals*
- *Food & Beverages*

## Benefits:

- *No Dead Legs*
- *Fully Self draining*
- *Ease of filter change-out*
- *Removable for Cleanability*
- *Maximize Product Recovery*
- *Crevice Free Electropolished surfaces with < 15 RA internal surfaces*



**International Filter Products**  
*Revolutionary systems for your industry*

7914 Ajay Drive, Sun Valley, CA 91352 • [www.internationalfilterproducts.com](http://www.internationalfilterproducts.com)  
E-mail: [sales@internationalfilterproducts.com](mailto:sales@internationalfilterproducts.com) • Phone: 818-504-8115



# SMR SERIES SANITARY STAINLESS STEEL MULTI-ROUND FILTER HOUSING

As shown in the photo below, the external design feature of our multi-round filter housings.

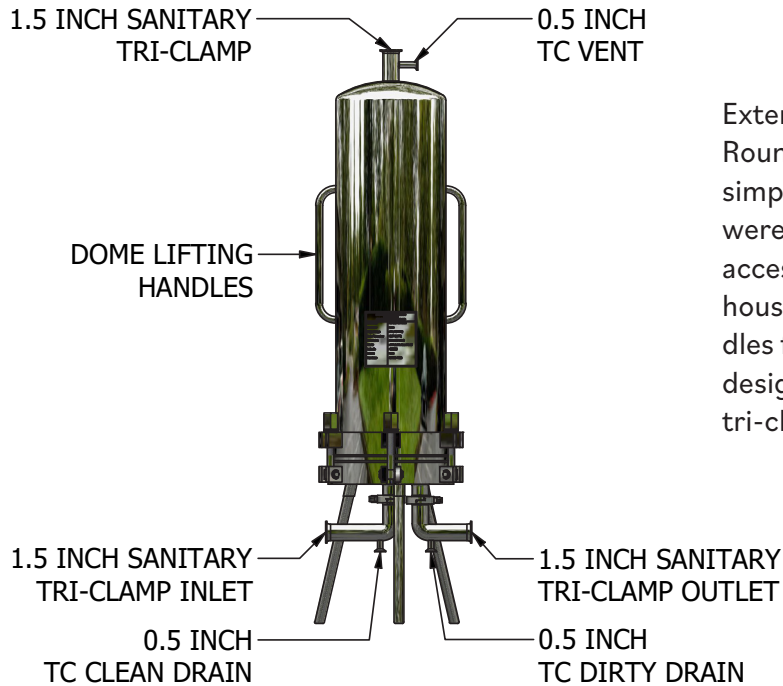

External Design Features - IFP's Sanitary Multi-Round Filter Housing is a aseptic design that is simple and convenient to use. The swing-away bolts were placed at the bottom of the dome to simplify access for filter change out and inspecting filter housing O-ring seals. The dome has large lifting handles for easy dome removal. The filter housing was designed easy venting, sampling, and draining with tri-clamp vents and drains.

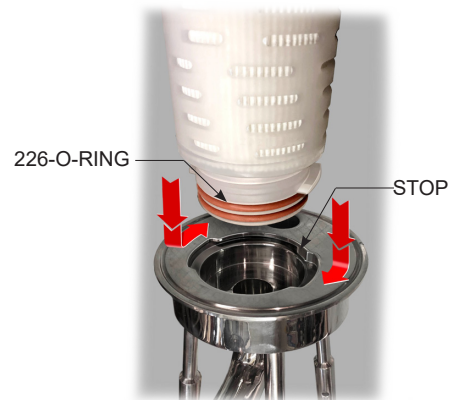

Internal Design Features - The objective of our Engineers was to design a filter housing that is aseptic and convenient to use. The retain plate can be removed for cleaning. The tie rods sterdy sealed at the bottom to make sure the threads are not exposed to the process fluid. The aseptic design of the retainer plate locking thumb screw has dynamic sealing to make sure there are no threads exposed to the process fluid.

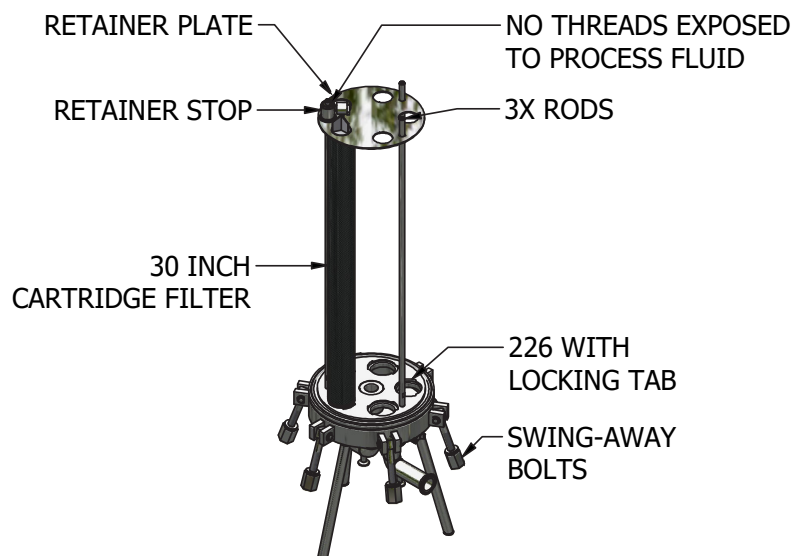

As shown in the photo above, the internal design feature of our multi-round filter housings.

# SMR SERIES SANITARY STAINLESS STEEL MULTI-ROUND FILTER HOUSING

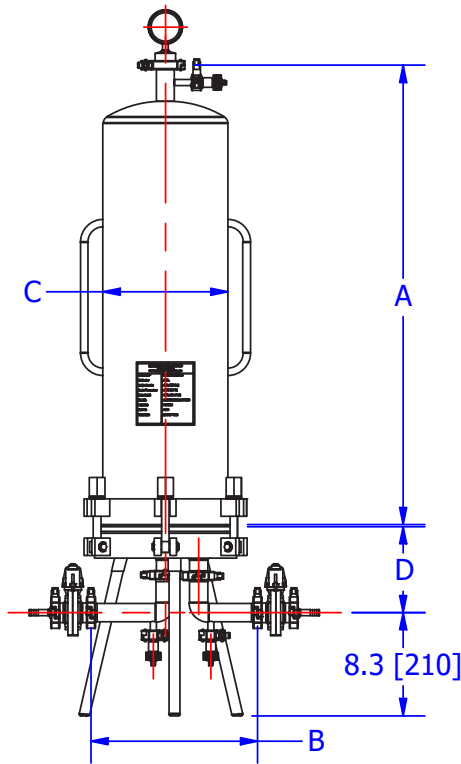

## Materials of Construction:

Head: 316L Stainless Steel  
Bowl: 316L Stainless Steel  
Clamp: 304 Stainless Steel  
Legs: 304 Stainless Steel  
Vent/ Drain: 316L Stainless Steel  
O-Rings: Silicone, EPDM, Buna N, or Kalrez

## Cartridge Dimension (nominal)

Lengths (in) 10, 20, 30 and 40

## Connections:

Inlet/ Outlet Sanitary Flange, refer to drawing.  
Vent/ Drain: 1/2 TC, see drawing.

## Finish:

Exterior Finish: Electropolished < 25RA  
Interior Finish: Electropolished < 16 RA

## Operating Conditions:

Max Operating Pressure, 125 PSI (10 Bar) @212 F (100 C)

| Element Length | 3-Round         | 5-Round          | 7-Round         | 9-Round          | 12-Round         |
|----------------|-----------------|------------------|-----------------|------------------|------------------|
| A - Dimension  | 10"             | 17 in [432mm]    | 17 in [432mm]   | 17 in [432mm]    | 17 in [432mm]    |
|                | 20"             | 26.4 in [669mm]  | 27 in [686mm]   | 26.9 in [684mm]  | 27.2 in [691mm]  |
|                | 30"             | 35.8 in [910mm]  | 36.9 in [937mm] | 37.2 in [945mm]  | 37 in [940mm]    |
|                | 40"             | 45.6 in [1158mm] | 47 in [1194mm]  | 46.5 in [1181mm] | 47.2 in [1199mm] |
| B - Dimension  | 13.4 in [340mm] | 13.4 in [340mm]  | 14.9 in [380mm] | 18.0 in [461mm]  | 21.4 in [543mm]  |
| C - Dimension  | 8.9 in [226mm]  | 10.0 in [255mm]  | 10.9 in [279mm] | 13.5 in [344 mm] | 16.2 in [411mm]  |
| D - Dimension  | 6.4 in [162mm]  | 6.9 in [176mm]   | 5.6 in [143mm]  | 8.2 in [208 mm]  | 9.5 in [242mm]   |

## NOMENCLATURE

| Housing Style | Style # | Element Length | Inlet/ Outlet | Filter Style  | Vent           | Drain          | Gauge Port  | Seal            | Cleaning Option |
|---------------|---------|----------------|---------------|---------------|----------------|----------------|-------------|-----------------|-----------------|
|               | XX-XXXX | -X             | -X            | -X            | -X             | -X             | -X          | -X              | -X              |
| 3-Round       | 01-0270 | 05 = 5.0"      | 1 = 1.0" TC   | 1 = 222 w/fin | 1 = 1/4" Valve | 2 = 1/4" Valve | 1 = 1.5" TC | S = Silicone    | 0 = No Cleaning |
| 5-Round       | 01-0280 | 10 = 10"       | 2 = 1.5" TC   | 2 = 226 w/fin | 2 = 1/2" TC    | 3 = 1/2" TC    |             | B = Buna N, FDA | C = Cleaning    |
| 7-Round       | 01-0290 | 20 = 20"       | 3 = 2.0" TC   |               |                |                |             | E = EPDM        |                 |
| 9-Round       | 01-0300 | 30 = 30"       | 4 = 2.5 TC    |               |                |                |             | K = Kalrez      |                 |
| 12-Round      | 01-0310 | 40 = 40"       | 5 = 3.0 TC    |               |                |                |             | TES = TES       |                 |
|               |         |                |               |               |                |                |             | TEV = TEV       |                 |
|               |         |                |               |               |                |                |             | V = Viton       |                 |



**International Filter Products**  
Revolutionary systems for your industry

7914 Ajay Drive, Sun Valley, CA 91352  
www.internationalfilterproducts.com  
sales@internationalfilterproducts.com  
Phone: 818-504-8115