



# No-Clean Aerosol Filling System

Put away the cleaning solvent! This revolutionary filling system delivers perfectly blended aerosols without the need to clean between fillings.

### No Cleanings

"No cleanings" means reduced operational costs, no cleaning solvent costs or hassles, and an increase in small quantity sale profits.

### Safe to Operate

Filling only starts with complete closure of a metal shatterproof door.

### Efficient & Waste Free

The entire paint contents are injected into the aerosol in one powerful movement with no loss of paint.

### Color Indicator on Cap

A portion of the paint seals to the cap during the filling process to indicate color in can.

*EZ Spray is for professional use only and requires the use of standard personal protective equipment.*

*Formulated for MAP® Ultra Low VOC paint only.*

### Compact Design

About the size of a coffee maker, the filling system requires minimal counter space and recommended air pressure of 110 PSI.



**MATTHEWS PAINT**

800.323.6593

[www.matthewspaint.com](http://www.matthewspaint.com)



EZ304 6/16

*mpc MATTHEWS PAINT and Droplet and Rounded Rectangle and MAP are registered trademarks of PPG Industries Ohio, Inc. EZ SPRAY logo is a trademark of PPG Industries Ohio, Inc.*

**MAP-LV2K15**  
EZ™ Spray 2K Aerosol Application System  
Système d'application en aérosol 2K EZ-Spray

**MAP®**  
ULTRA LOW VOC



**MATTHEWS PAINT • 800-323-6593**

Must be activated prior to use to obtain full properties.  
Pour optimiser ses propriétés, ce produit doit être activé avant d'être utilisé.  
Read cautions and emergency instructions elsewhere on this label.  
Lea las precauciones y las instrucciones de emergencia que aparecen en otro lugar de esta etiqueta.

341 Grams

# MAP<sup>®</sup> Ultra Low VOC in an Aerosol



**Quickly and Easily  
Repair Scratched  
or Damaged Signs!**



This environmentally friendly, high-performance polyurethane paint provides greater durability, gloss retention and hiding than standard acrylic polyurethane paints.

## Paint & Hardener in One Can

EZ Spray's 2-component technology comprises MAP<sup>®</sup> Ultra Low VOC and hardener in one can. The hardener is integrated in a separate cylinder and is released when the drive pin punctures the cylinder.

## Features & Benefits

- Custom MAP<sup>®</sup> Ultra Low VOC paint, catalyst and propellant in an aerosol can
- Durable two-part, professional polyurethane system
- Theoretical transfer efficiency is 30% better than conventional spray equipment
- Four times the pot life of conventional spray process
- Any formula available today can be loaded into the can
- Excellent for repairs in the field
- Color indicator on cap depicts color in can
- Covers 8-12 sq ft @ 2 mil per can
- 6H compliant

Red plunger

Nozzle

Feed pipe and valve

Propellant

Paint

Hardener

Red plunger

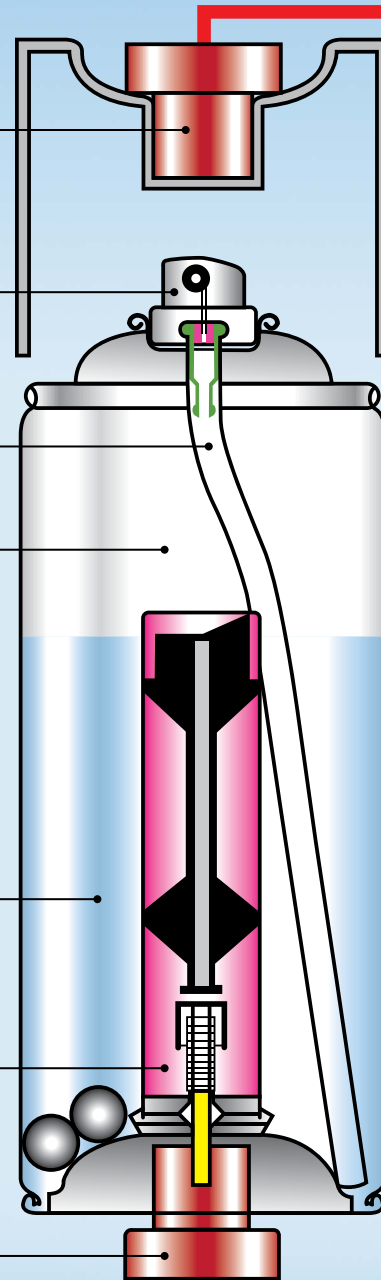

## EZ to Prepare Can for Application

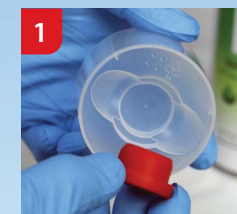

Remove bottom cap from can and red plunger from cap.



Attach red plunger to drive pin on bottom of can.



With both hands, push down swiftly on can to puncture hardener cylinder inside.



Remove red plunger and shake can for one minute, rotating every 15 seconds.



Remove top cap. Turn can upside down and away from you. Purge can.

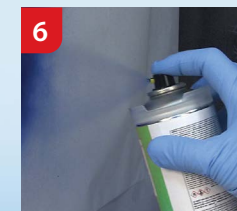

Turn can upright and perform spray test.